

BI-DIRECTIONAL KNIFE GATE VALVE

The definition variables are as follows:

B = Max. width of the valve (without actuator).

D= Max. height of the valve (without actuator).

OPTIONS:

- Locking devices.
- Extensions: stand, pipe, plates.
- DN above those given in the table

ACTUATOR:

- Handwheel
- Stem
- Nut
- Stem protection bonnet

AVAILABLE:

- Santdard ND50 to DN600.
- From ND600 the actuator is with gears.

* Other ND on request.

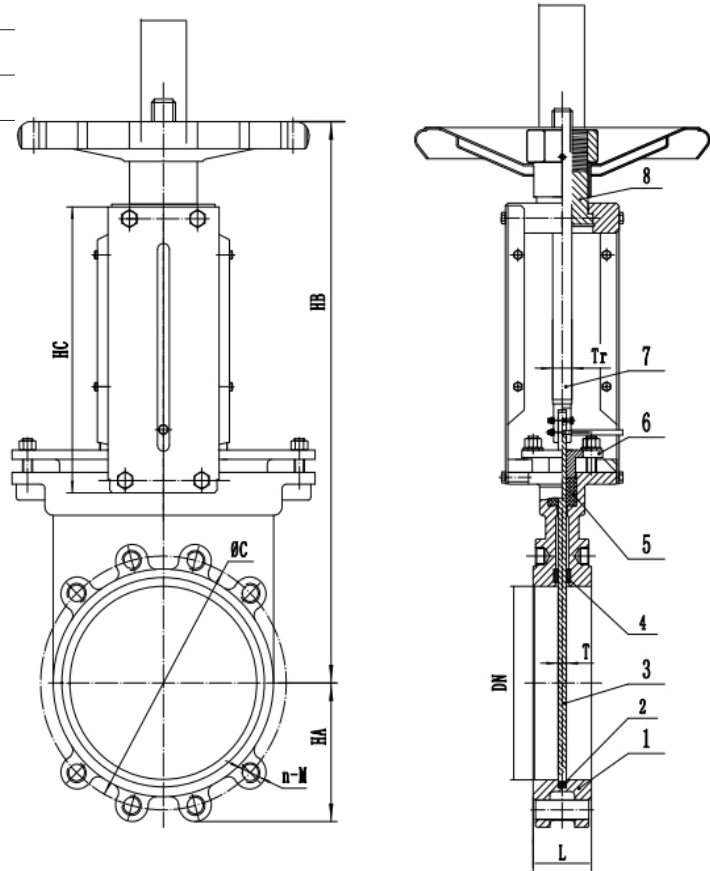

DN	ΔP (bar)	L	B	HA	D	F	HA	ϕV	WEIGHT (kg.)
50	10	40	91	61	241	410	280	225	7
65	10	40	91	68	268	437	308	225	8
80	10	50	91	91	294	463	333	225	9
100	10	50	91	104	334	503	373	225	11
125	10	50	101	118	367	586	407	225	13
150	10	60	101	130	419	638	458	225	17
200	8	60	118	159	525	816	578	325	28
250	6	70	118	196	626	1017	679	325	40
300	6	70	118	230	726	1117	779	380	56
350	5	96	290	254	797	1337	906	450	94
400	5	100	290	287	903	1443	1012	450	116
450	3	106	290	304	989	1629	1098	450	162
500	3	110	290	340	1101	1741	1210	450	187
600	3	110	290	398	1307	2047	1416	450	260

GEAR BOX-BI-DIRECTIONAL KNIFE GATE VALVE

The definition variables are as follows:

B = Max. width of the valve (without actuator)

P = Max. height of the valve (without actuator)

OPTIONS:

Chainwheel

- Extensions: stand, pipe, plates...
- Locking devices
- Non-rising stem

ACTUATOR:

- Stem
- Yoke
- Cone-shaped gear box
- Handwheel
- Standard ratio = 4 to 1.

AVAILABLE:

- ND50 to DN600.

* Other ND on request.

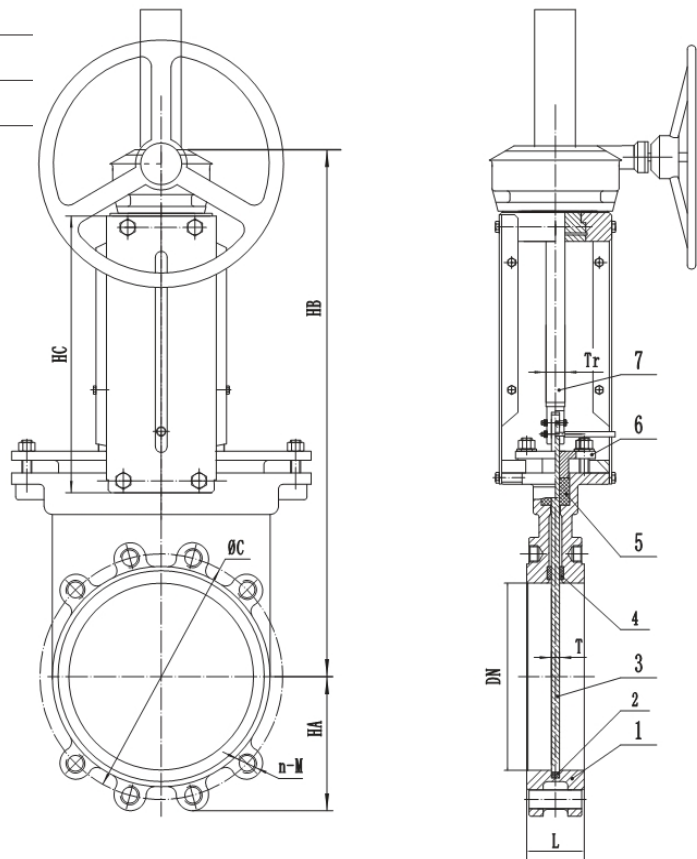

DN	ΔP (bar)	L	B	HA	D	HB	P	øVc	WEIGHT (kg.)
50	10	40	91	61	241	366	540	300	20
65	10	40	91	68	268	392	566	300	21
80	10	50	91	91	294	418	592	300	22
100	10	50	91	104	334	458	632	300	24
125	10	50	101	118	367	491	665	300	26
150	10	60	101	130	419	543	717	300	30
200	8	60	118	159	525	648	942	300	41
250	6	70	118	196	626	749	1033	300	53
300	6	70	118	230	726	850	1121	300	69
350	5	96	290	254	797	891	1305	450	107
400	5	100	290	287	903	997	1403	450	130
450	3	106	290	304	989	1083	1677	450	183
500	3	110	290	340	1101	1195	1789	450	204
600	3	110	290	398	1307	1401	1995	450	288